

A-59-82  
3481

Courses Down the Susquehanna-

- N. 3 1/2 E. 56.
  - N. 40 E. 25.
  - N. 57 E. 37.
  - N. 75 1/4 E. 33.
  - N. 87 E. 36.
  - N. 77 E. 29.
  - N. 74 E. 31.
  - N. 63 E. 32.
  - N. 52 1/4 E. 17.
  - N. 39 E. 13.
  - N. 23 1/2 E. 11.
  - N. 19 E. 33.
  - N. 13 1/4 E. 23.
  - N. 12 1/2 W. 78.
  - N. 6 W. 59.
  - N. 21 W. 45.
  - N. 9 W. 82.
  - North 24.5
  - N. 7 1/2 W. 26.
  - N. 10 W. 23.
  - N. 7 1/2 W. 14.
  - N. 12 1/2 E. 18.
  - N. 22 1/2 E. 58.
  - North 56.
  - N. 8 W. 78.
  - N. 10 E. 31.
  - N. 23 3/4 E. 25
- 993.5

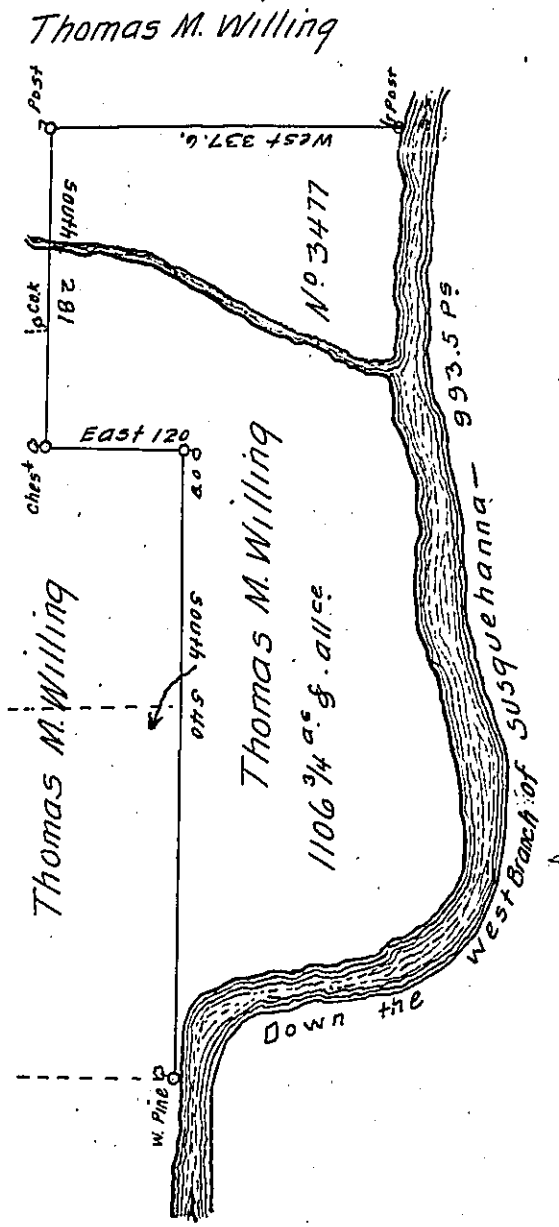

3490  
3491

Surveyed the above described Tract of Land on 5<sup>th</sup> day of the 6<sup>th</sup> mo. 1794  
 for Thomas M. Willing in pursuance of his Warrant N<sup>o</sup> 3477.  
 Dated the 14<sup>th</sup> day of decem<sup>r</sup> 1792 Situate on the West Branch of Susque-  
 hanna - adjoining his other Land Containing Eleven hundred & Six  
 Acres & three Quarters & the allowance of Six & Cent.

Daniel Brodhead Esq<sup>r</sup>                      William Ellis D.S.  
 Surveyor General

IN TESTIMONY that the above is a copy of the original remaining on file in  
 the Department of Internal Affairs of Pennsylvania, made  
 conformably to an Act of Assembly approved the 16th day of  
 February, 1833, I have hereunto set my Hand and caused  
 the Seal of said Department to be affixed at Harrisburg,  
 this eighth day of April 1907.

*Geo. R. Brown*  
 Secretary of Internal Affairs.